

# Stan Patrol 4207

STANDARD



## PICTURE OF SIMILAR VESSEL

### GENERAL

Hull material	Steel
Superstructure material	Aluminium
Basic functions	Patrol duties, maritime safety, securing economical waters, search and rescue
Classification	Bureau Veritas I ✱ Hull • MACH • AUT UMS Light Ship / Fast Patrol Boat Sea Area 3

### DIMENSIONS

Length overall	42.8 m
Beam overall	7.1 m
Depth at side	3.8 m
Draught max	2.5 m
Gross tonnage	241
Crew	Up to 18 persons

### TANK CAPACITIES

Fuel oil	30.7 m <sup>3</sup>
Fresh water	6.4 m <sup>3</sup>
Waste water (black)	2.2 m <sup>3</sup>
Waste water (grey)	6.4 m <sup>3</sup>
Bilge water / dirty oil	1.3 m <sup>3</sup>

### PERFORMANCES

Speed	Up to 26.5 kn
Range at cruising speed (12kn)	Up to 2,500 nm

### PROPULSION SYSTEM

Main engines	2x Caterpillar
Total Power	Up to 4,700 bkW
Gearboxes	2x Reintjes WLS series
Propulsion	2x controllably pitch propellers
Bow thruster	1x 75 kW hydraulically driven

### ELECTRICAL EQUIPMENT

Network	24V DC, 230V/400V 50Hz AC
Generator sets	2x 86 ekW

### DECK LAY-OUT

Anchor equipment	1x HHP Pool TW, chain, hydraulic winch
Slipway	

### SHIP SYSTEMS

Ship systems are according to Class	
Fuel filtration	1x Filter separator
Engine room ventilation	2x supply fan, in total 53,000 m <sup>3</sup> /hr
Air conditioning	325,000 BTU/hr
Fire extinguishing	Fixed aerosol system in engine room
Roll reduction	Hydraulically driven stabilizer fins

### ACCOMMODATION

Bridge deck	Wheelhouse
Main deck	Crew cabins, officers room, galley, mess rooms, sanitary spaces, stores
Lower deck	Crew cabins, sanitary spaces, stores, laundry

### NAUTICAL AND COMMUNICATION EQUIPMENT

Integrated nav system	1x
Searchlight	1x
Radar	1x X-band, 1x S-band
Electronic Chart	Single ECDIS
GPS	2x DGPS
AIS	1x
Compass	1x Magnetic, 1x Gyro
Autopilot	1x
Echo sounder	1x
Speed log	1x
Internal communication	Intercom and public address system
CCTV system	1x
External communications	GMDSS A2
Weather system	1x

### OPTIONAL

Flying bridge	
Bilge water separator	
Fresh water maker	
Sewage treatment plant	
Generators parallel operation	
Electrical network	110V / 440V 60Hz AC
Foldable deck crane	
Slipway RHIB	7.5m, >30 knots
External fire-fighting	With foam
Second searchlight	
Night vision camera	
External communication	GMDSS A3
Data communication	Fleet Broadband, V-Sat
Military equipment / ballistic protection	
Alternative layout main deck or lower deck	

Note: Delivery of vessel and/or equipment may be export-controlled

# Stan Patrol 4207

STANDARD

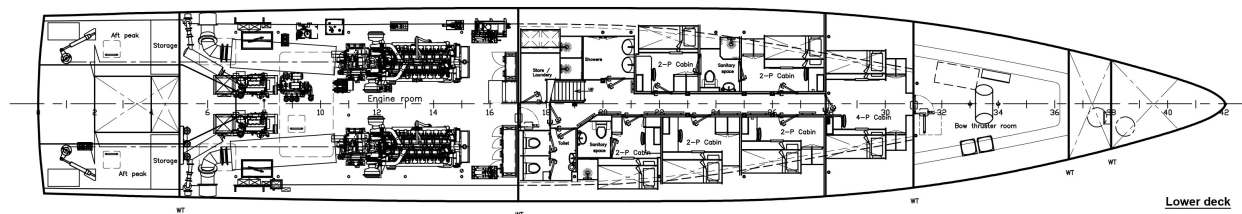
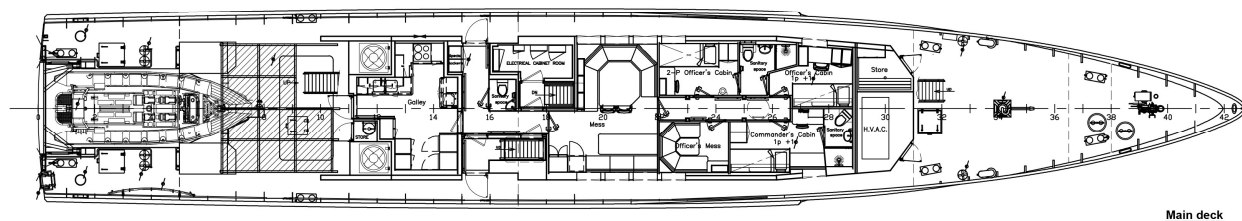
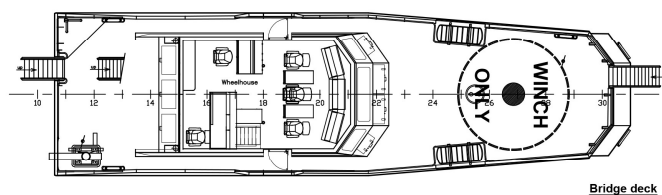
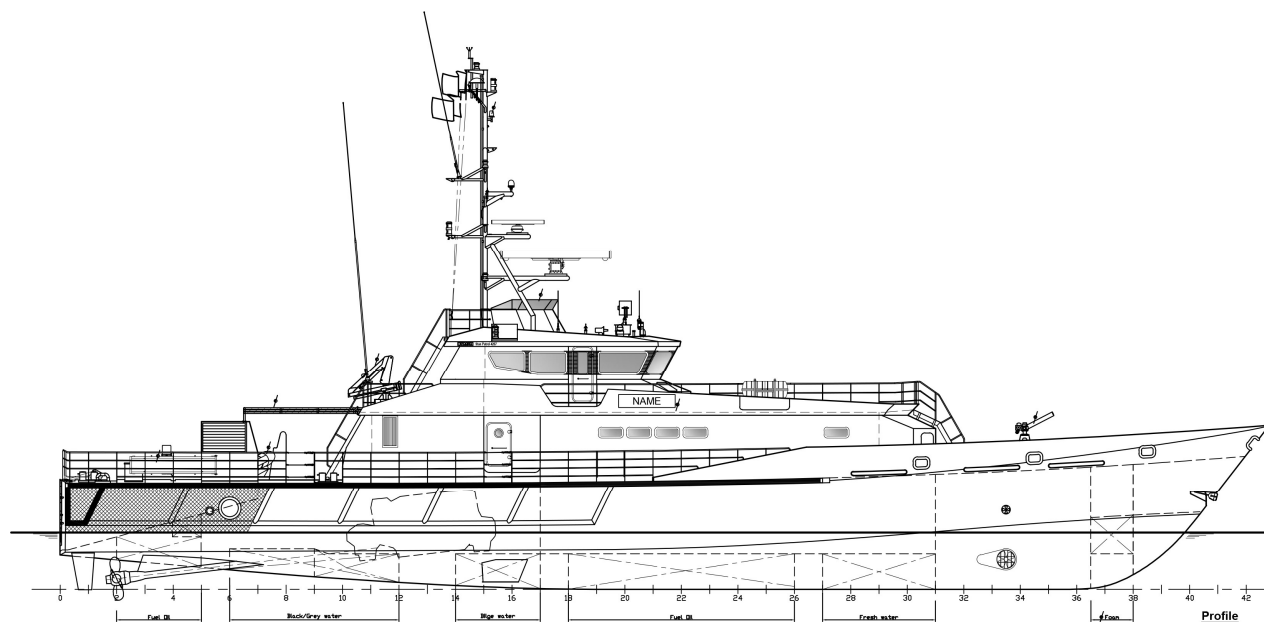

Items marked with  are optional equipment

**DAMEN**

Damen.com

© No part of the leaflet may be reproduced in any form, by print, photo print, microfilm, or any other means, without written permission from Damen Shipyards Group